

SUMMARY
CONSULTATION
DOCUMENT

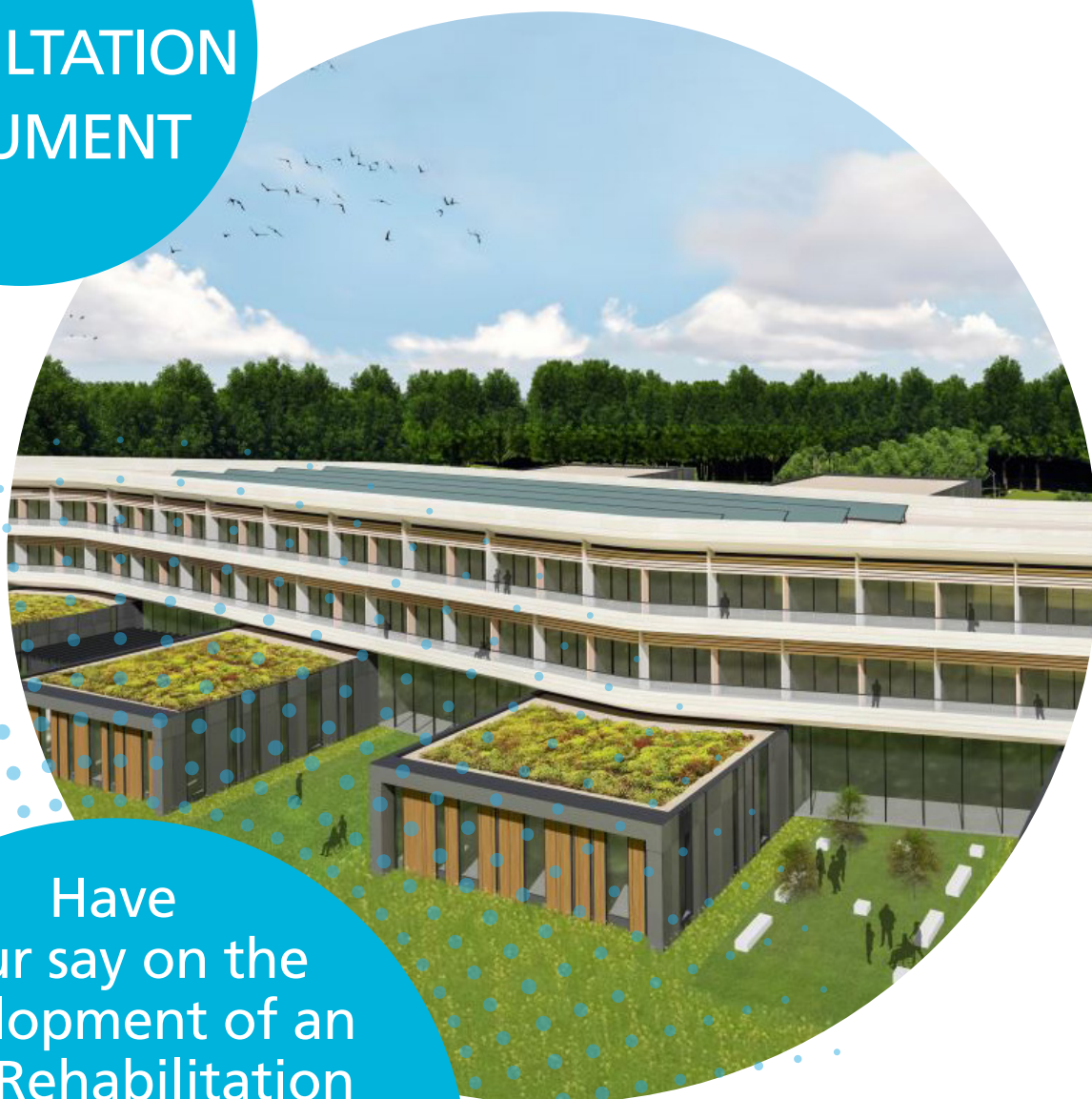

Have
your say on the
development of an
NHS Rehabilitation
Centre on the Stanford
Hall Rehabilitation
Estate - part of the
vision for a National
Rehabilitation
Centre

This
consultation
will run from
27 July 2020
through to
18 September
2020

What we are consulting on

We are consulting on the development of a new rehabilitation centre for NHS patients in the East Midlands.

We are consulting on whether or not to take forward this opportunity, including the proposed transfer of existing services to the new facility. The funding and land are only available to develop an NHS Rehabilitation Centre (NHSRC) at the Stanford Hall Rehabilitation Estate (SHRE), so we are consulting on this single option, delivering rehabilitation. The centre will be purpose built for rehabilitation and will provide an enhanced service for patients, with access to state-of-the-art facilities.

This is a unique opportunity to provide NHS services to NHS patients while benefitting from a co-located site with specialist military rehabilitation services.



How did this consultation come about?

- In 2018 the government provided £70m for the construction of an NHSRC on the SHRE. This is part of the vision for a National Rehabilitation Centre (NRC). The aim is to create a centre of excellence for rehabilitation. The government funding has been allocated specifically for that purpose.
- The NHSRC would be a standalone NHS facility, located close to the Defence Medical Rehabilitation Centre (DMRC) at the SHRE. Patients referred there would have access to some of the military rehabilitation facilities, but would be treated by NHS staff in a separate building. This is a unique opportunity to provide NHS services to NHS patients while benefitting from a co-located site with specialist military rehabilitation services.
- The NHS Nottingham and Nottinghamshire Clinical Commissioning Group (CCG) is considering the opportunity to commission NHS rehabilitation services to be provided at SHRE. This would mean transferring existing NHS rehabilitation services in Nottingham at Linden Lodge on the City Hospital campus to the new facility. The centre will be purpose built for rehabilitation and provide an enhanced service for patients, with access to state-of-the-art facilities.

We want to hear from everyone who has an interest in improving NHS services.

Who do we want to hear from?

We want to hear from anyone who has had direct or indirect experience of rehabilitation - either as a patient or through family members or friends. This includes those living in neighbouring areas including Leicestershire, Derbyshire and Lincolnshire as well as those living in Nottinghamshire, due to their proximity to existing specialist rehabilitation services in the area.

Why do we need a rehabilitation centre?

Evidence suggests that patients including those who have experienced major trauma, brain injuries, complex musculoskeletal injuries, traumatic amputation and spinal cord injuries will receive better care and have an improved chance of returning to their lives more quickly, if they have access to a specialist team and facilities all coordinated together under one roof during their time in hospital.

The map shows where neurological rehabilitation services at the level of those proposed to be provided at the NHSRC are currently provided across the East Midlands and also indicates where the SHRE is located.

Musculoskeletal rehabilitation is not currently provided in the East Midlands but would be available at the NHSRC.

The British Society of Rehabilitation Medicine recommends that the ideal level of rehabilitation beds should be 45 to 65 beds per million people. There is currently a significant shortfall of these beds in the East Midlands, which the proposed NHSRC would contribute to improving.



Where will the rehabilitation centre be located?



The British Society of Rehabilitation Medicine (BSRM) recommends that the ideal level of rehabilitation beds should be 45 to 65 beds per million people. There is currently a significant shortfall of these beds in the East Midlands, which the proposed NHSRC would contribute to improving.

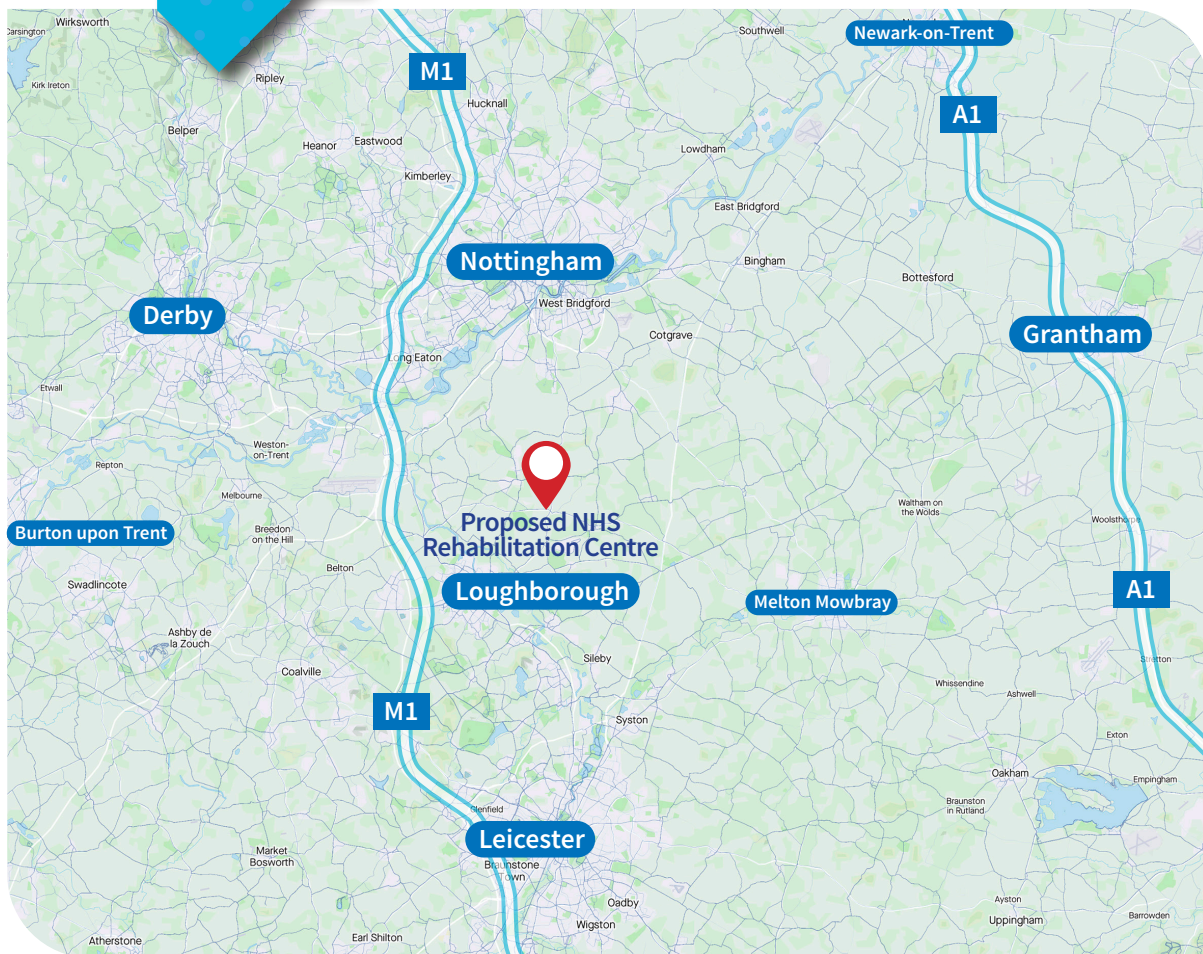

What have people told us so far?

In developing this proposal, we have listened to patients, carers and staff working in our rehabilitation services. During two periods of patient and staff engagement in July 2019 and October 2019, we held a series of meetings and events with patients who would potentially be eligible to benefit from access to the NHSRC because of the complexity of their rehabilitation needs.

While the people we spoke to were mostly positive about the proposal, a number of concerns were also raised. These were around the location and accessibility of the facility; the potential for patients to feel lonely and isolated, and the impact on local services. Some raised concerns about the impact on local services such as Linden Lodge at Nottingham City Hospital. In developing the proposal we are now consulting on, we have considered how best to respond to these concerns.

More information on the engagement and options development can be found in the full consultation document available at <https://nottscg.nhs.uk/rehab-centre-consultation/>.



Have your say

We would like you to provide your feedback on the proposal to establish an NHS Rehabilitation Centre and you can do this in a number of ways, as set out below.

To find out more about the consultation on the future of specialist rehabilitation services in the East Midlands and complete a survey on-line, visit: <https://www.surveymonkey.co.uk/r/NHS-RC>.

To request a copy of the consultation document or a paper copy of the questionnaire, or if you have any other queries regarding this consultation, please email NECSU.engagement@nhs.net or call **0115 906 8846**.

To hear first-hand from clinical leaders about the consultation on the future of specialist rehabilitation services in the East Midlands and ask questions, register to attend one of the following virtual events. These virtual events will take place via Microsoft Teams and joining instructions will be shared once you have registered.

Engagement events	Dates	Times	Register to attend
1.	Tuesday 4 August 2020	3-4pm	http://NHSrehabcentre.eventbrite.com
2.	Monday 10 August 2020	2.30-3.30pm	http://NHSrehabcentre.eventbrite.com
3.	Tuesday 19 August 2020	6-7pm	http://NHSrehabcentre.eventbrite.com
Focus groups	Late August 2020 (tbc)	(tbc)	http://NHSrehabcentre.eventbrite.com

(These meetings will be carried out via Microsoft Teams and joining instructions will be provided once people have registered.)

Join a focus group

We will also be running a series of focus groups to explore the issues raised in the consultation in further detail. To join these groups, please get in touch with us via the details in the Contact Us section of this document.



What happens next?

No decision will be made until after the consultation has closed. After this consultation closes, the responses we receive will be independently analysed and a report on the data received will be prepared for the NHS organisations leading the consultation.

A central graphic featuring a solid blue circle with the text 'Contact us' in white. This circle is surrounded by several concentric circles of light blue dots that fade out towards the edges of the page. Two horizontal blue lines extend from the left and right sides of the central blue circle.

Contact us

Please call us on: **0115 906 8846**.

Email: NECSU.engagement@nhs.net.

To request this document in an alternative format contact us using the details above.